

YE-119X DIN CABLE PLUG METAL SHIELD ASS'Y

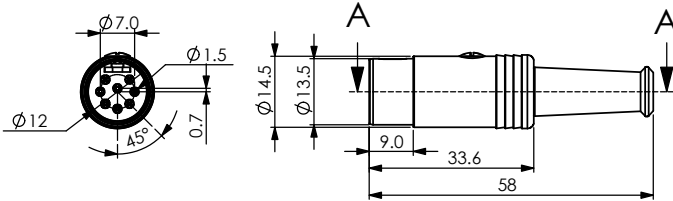
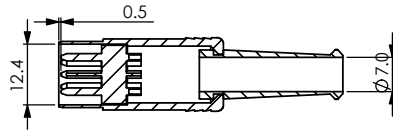

MATERIAL :

1. SHIELD COVER : BRASS NICKEL PTD.
2. STRAIN BOOT : TPR
3. SET SCREW : STEEL NICKEL PTD.
4. "T" HOLDER : STEEL NICKEL PTD.
5. HOUSING : PA66
6. TERMINALS : BRASS SILVER PTD.

SPECIFICATION :

Rating : 100V AC 1A max.
 Contact Resistance :
 Pins 30mΩ max.
 Shell 50mΩ max.
 Insulation Resistance :
 100MΩ at 500V DC min.
 Voltage Withstand :
 250V AC for 1 minute

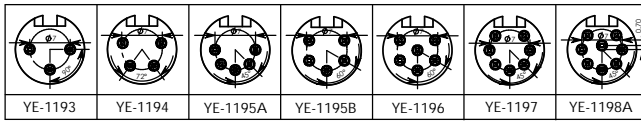

YE-1193	YE-1194	YE-1195A
YE-1195B		YE-1196
YE-1197	YE-1198A	YE-1198B